

**SHEET NO. 66 OF THE ZONING DISTRICT MAP OF BALTIMORE CITY ZONING CODE**

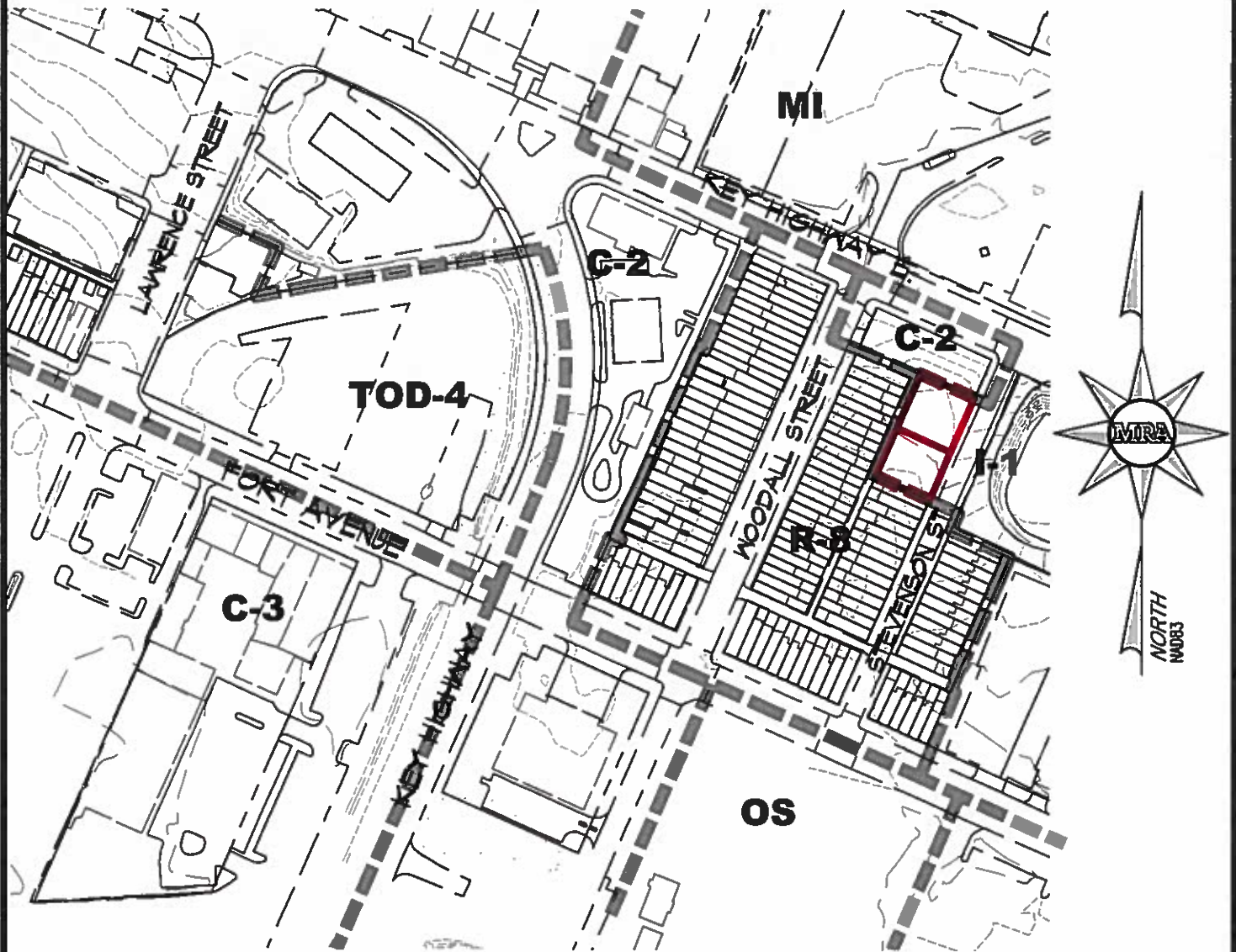

\_\_\_\_\_  
MAYOR

\_\_\_\_\_  
PRESIDENT CITY COUNCIL

**NOTE:**

IN CONNECTION WITH THE PROPERTY KNOWN AS 1401 WOODALL ST AND 1446 STEVENSON STREET, THIS APPLICANT WISHES TO REQUEST THE REZONING OF THE AFOREMENTIONED PROPERTY FROM I-1 ZONING TO C-2 ZONING, AS OUTLINED IN RED ABOVE.



**MORRIS & RITCHIE ASSOCIATES, INC.**  
ENGINEERS, ARCHITECTS, PLANNERS, SURVEYORS AND LANDSCAPE ARCHITECTS  
1414 KEY HIGHWAY, SUITE 201P  
BALTIMORE, MD 21230  
(410) 935-5050  
SDAVIS@MRAGTA.COM  
MRAGTA.COM  
Copyright 2017 Morris & Ritchie Associates, Inc.

**1401 WOODALL STREET &  
1446 STEVENSON STREET**  
LOT. 32 & 33

WARD 24, SECTION 10, BLOCK 2016  
BALTIMORE CITY, MARYLAND

SCALE: 1" = 200'	DATE: 9/13/17	DRAWN BY: BNS	DESIGN BY: BNS	REVIEW BY: SDD	JOB NO. : 9999
------------------	---------------	---------------	----------------	----------------	----------------

149