

**SHEETS No. 32,33,42,43 OF THE ZONING DISTRICT MAP OF THE BALTIMORE CITY ZONING CODE.**

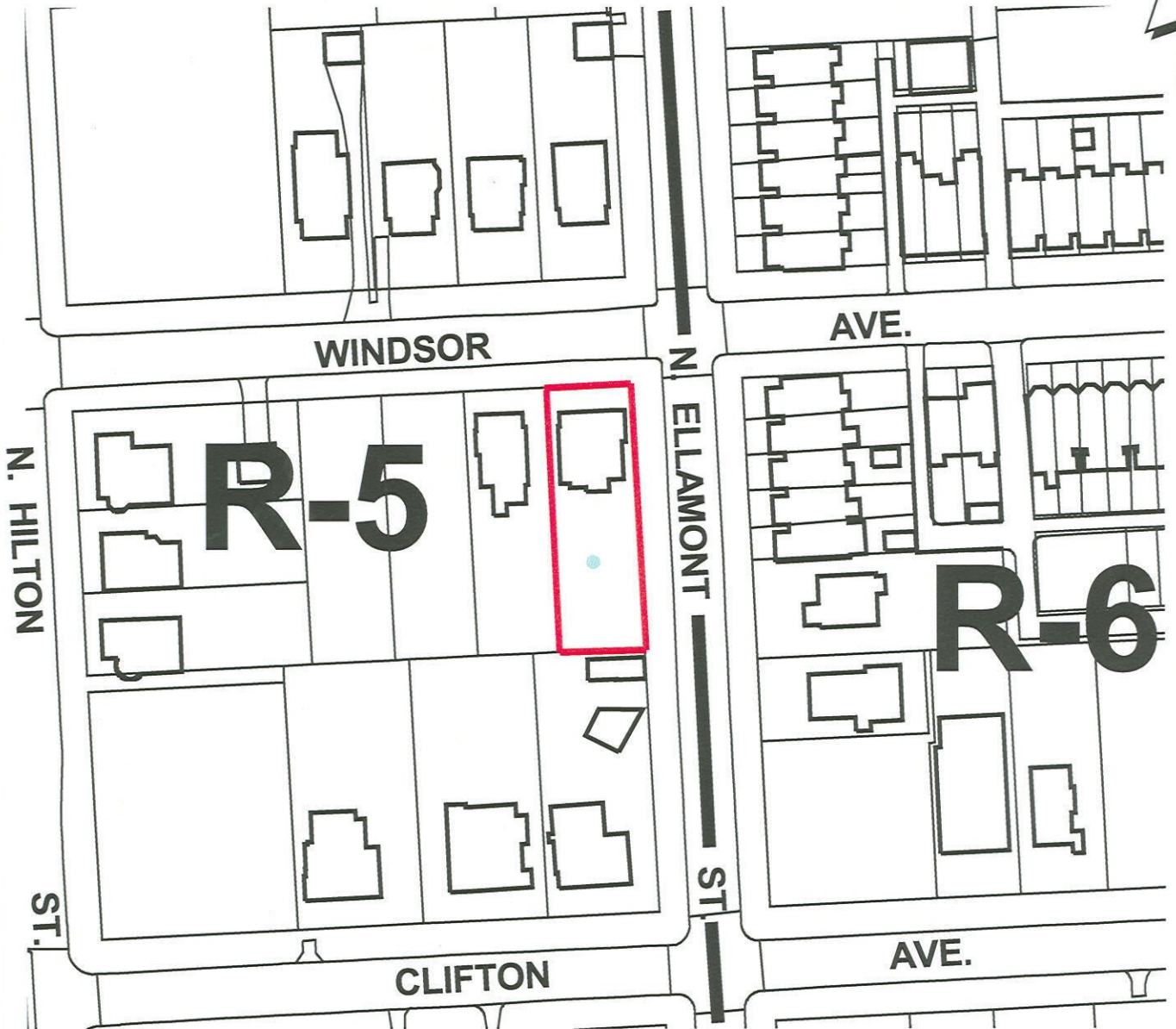

SCALE: 1"=100'

**NOTE: IN CONNECTION WITH PROPERTY KNOWN AS 3201 WINDSOR AVE. THE APPLICANT WISHES TO REQUEST THE CONDITIONAL USE OF THE PROPERTY FOR ASSISTED LIVING AS OUTLINED IN RED.**

**WARD-15 SECTION-29 BLOCK-3020 LOT-005**

\_\_\_\_\_

**MAYOR**

\_\_\_\_\_

**PRESIDENT CITY COUNCIL**