

SHEET NO. 64 OF THE ZONING DISTRICT MAP OF BALTIMORE CITY ZONING CODE

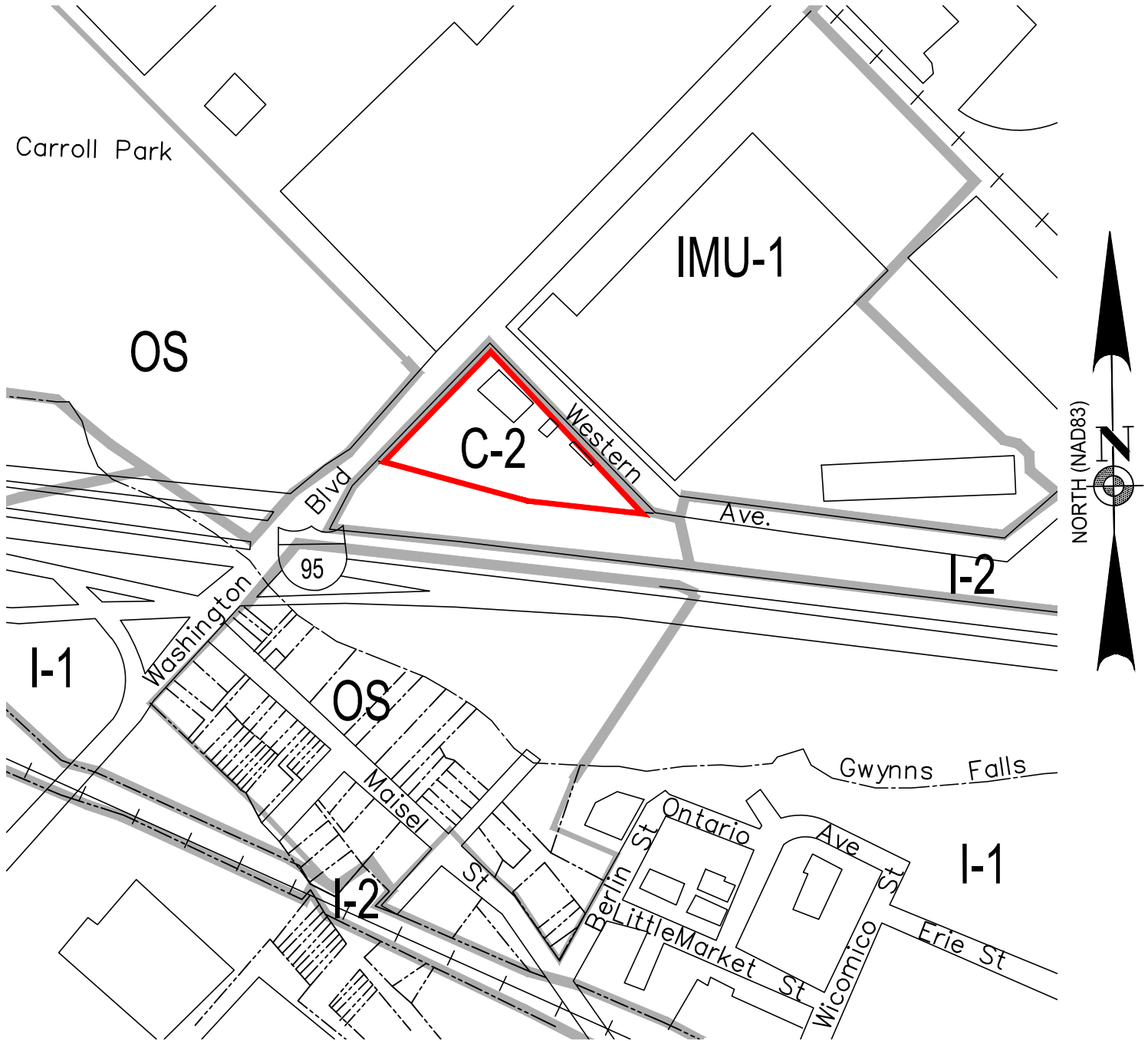

MAYOR

PRESIDENT CITY COUNCIL

**NOTE:**  
 IN CONNECTION WITH THE PROPERTY KNOWN AS 2101 WASHINGTON BLVD. THIS APPLICANT WISHES TO REQUEST THE REZONING OF THE AFOREMENTIONED PROPERTY FROM C-2 ZONING TO I-1 AS OUTLINED IN RED ABOVE.

**CMS Associates LLC**

4925 Ellis Lane  
 Ellicott City, Maryland 21043  
 Tel. (410) 988-2436  
 Contact: Geoffrey L. Ciniero, PE  
 www.cms-engineering.net

2101 WASHINGTON BLVD.  
 LOT 6

WARD 21 SECTION 05 BLOCK 770  
 BALTIMORE CITY, MARYLAND