

**SHEET NO. XX OF THE ZONING DISTRICT MAP
OF THE BALTIMORE CITY ZONING CODE**

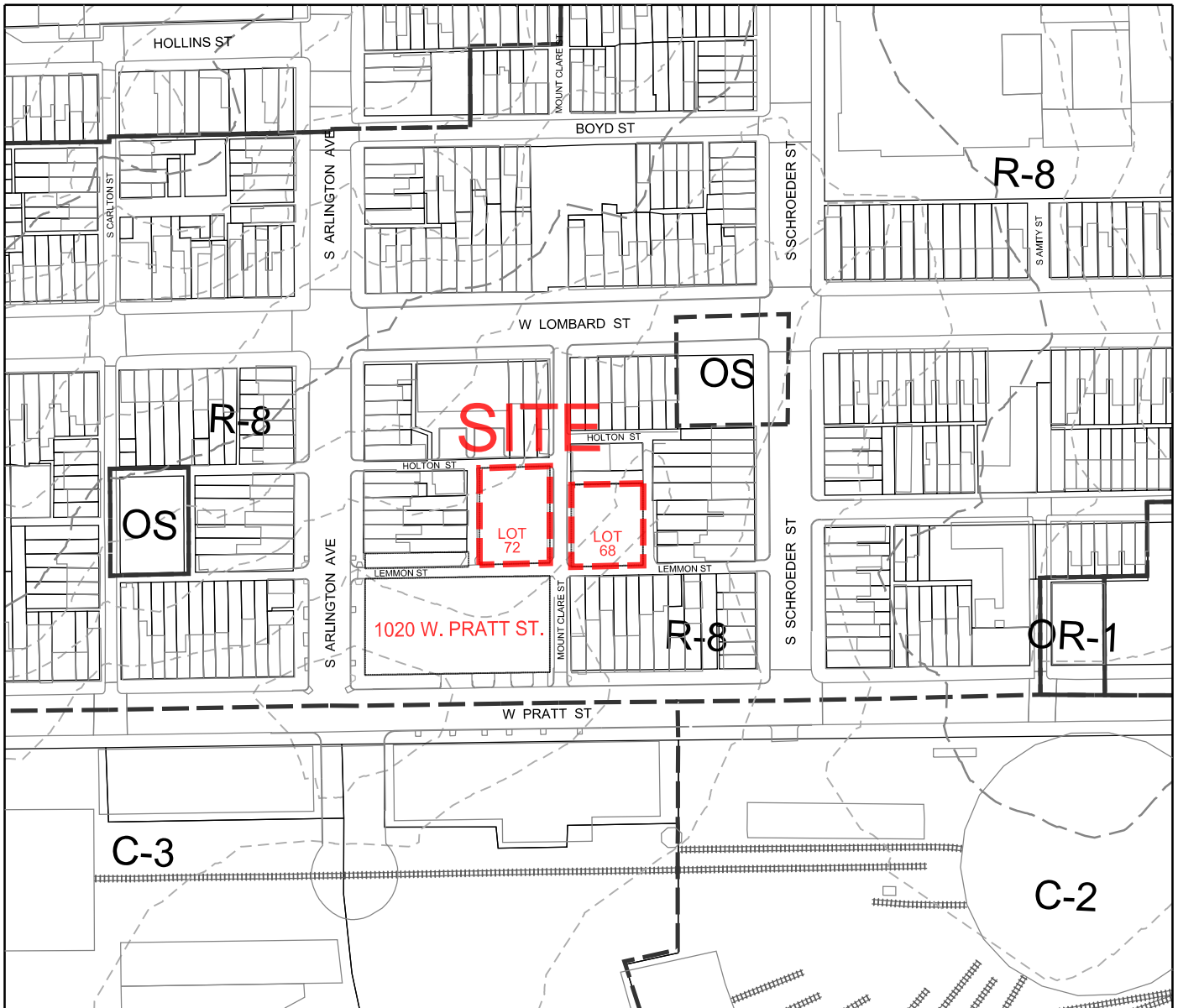

NOTE:

THE APPLICANT REQUESTS, FOR THE PURPOSE OF PERMITTING, SUBJECT TO CERTAIN CONDITIONS, THE ESTABLISHMENT, MAINTENANCE, AND OPERATION OF OPEN OFF-STREET PARKING AREAS TO SERVE THE BUILDING AT 1020 W. PRATT STREET ON THE PROPERTIES AS OUTLINED HEREON IN RED.

MAYOR

PRESIDENT CITY COUNCIL

PLAT PREPARED BY:



STV INCORPORATED
7125 AMBASSADOR ROAD, STE 200
BALTIMORE, MD 21244

APPLICANT

INNOVATION ALLEY, LLC
900 E. FORT AVE., STE 900
BALTIMORE, MD 21230

C/O TODD JAMES
PHONE: (443) 478-1200

PLAT TO ACCOMPANY CONDITIONAL USE

1020 WEST PRATT STREET

1020 WEST PRATT STREET
BALTIMORE, MD 21223

WARD: 18 SECTION: 8 BLOCK: 251 LOTS: 68, 72

SCALE: 1"=150'

DATE: AUG. 7, 2020