

1" = 100'

Note:

In Connection With Property Known As
No. 4410 Pall Mall Road.
The Applicant Wishes To Request
The Conditional Use Of The Aforementioned Property As A
PARKING, OPEN OFF STREET AREA (PARKING LOT),
As Outlined In Red Above.

WARD - 15 SECTION - 34 BLOCK - 3349 LOT - 35

MAYOR

PRESIDENT CITY COUNCIL

677

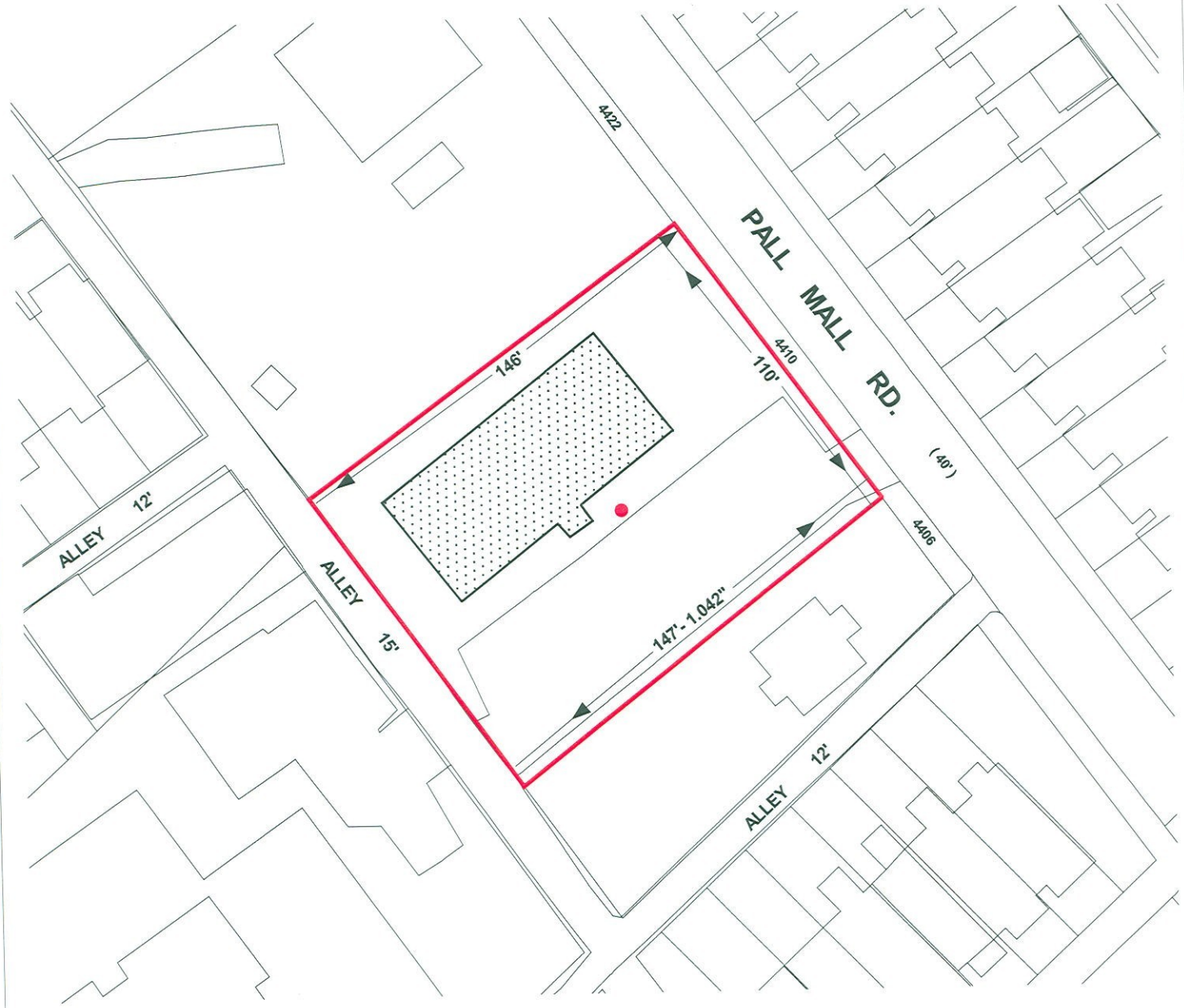

1" = 50'

4410 PALL MALL ROAD

Sheet #2