

NO.	REVISIONS	DATE	BY

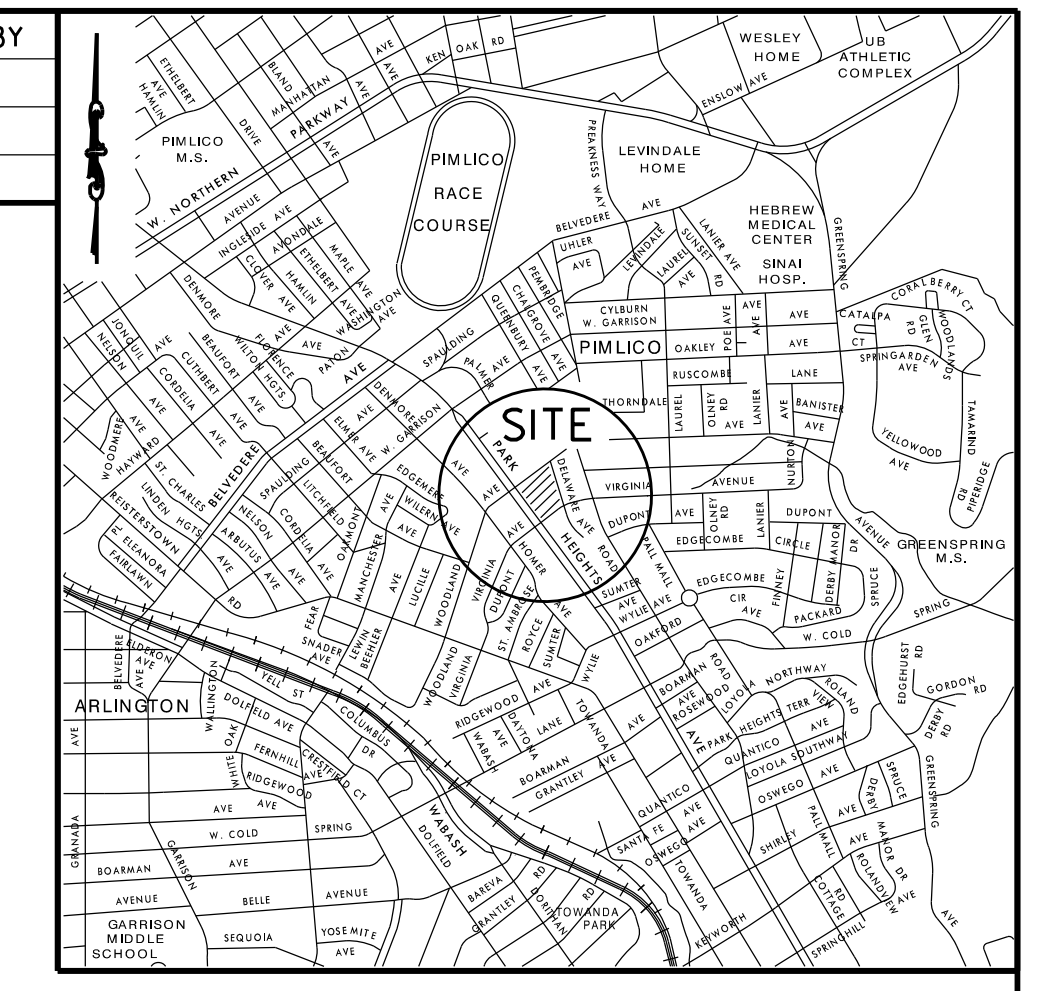

COURSES AND DISTANCES

- PARCEL NO. 1** □
1. SOUTHWESTERLY 128.5'±
 2. NORTHWESTERLY 10.0'
 3. NORTHEASTERLY 132.1'±
 4. SOUTHEASTERLY 10.6'±
- AREA: 1,303 SQUARE FEET
0.030 ACRES±
- PARCEL NO. 2** ◻
1. NORTHWESTERLY 395.0'±
 2. NORTHEASTERLY 10.0'
 3. SOUTHEASTERLY 395.0'±
 4. SOUTHWESTERLY 10.0'
- AREA: 3,950 SQUARE FEET
0.091 ACRES±
- PARCEL NO. 3** ○
1. SOUTHEASTERLY 10.6'±
 2. SOUTHWESTERLY 198.5'
 3. NORTHWESTERLY 10.0'±
 4. NORTHEASTERLY 202.2'±
- AREA: 2,002 SQUARE FEET
0.046 ACRES±

GENERAL NOTES

1. THIS PLAT WAS PREPARED USING AVAILABLE DEEDS AND BALTIMORE CITY BLOCK PLAT INFORMATION.
2. THIS PLAT WAS PREPARED WITH THE BENEFIT OF TITLE SEARCHES PROVIDED BY THE LAW OFFICE OF HENRY I. LOUIS, DATED OCTOBER 1st AND 2nd, 2018.
3. AN EASEMENT WILL BE RETAINED FOR ALL UTILITIES NOT TO BE ABANDONED.
4. ANY UNDERGROUND UTILITIES SHOWN HEREON WERE COMPILED FROM BALTIMORE CITY UTILITY RECORD DRAWINGS, AND ARE FOR THE CONVENIENCE OF THE USER OF THE DRAWING, AND THE CITY OF BALTIMORE OFFERS NO WARRANTY OR GUARANTEE AS TO THE ACCURACY, CORRECTNESS, COMPLETENESS, EXISTENCE OR NON-EXISTENCE OF THE INFORMATION SHOWN HEREON. THE USER OF THIS PLAT MUST VERIFY ALL SUCH INFORMATION TO HIS/HER OWN SATISFACTION.
5. N/F = NOW OR FORMERLY.

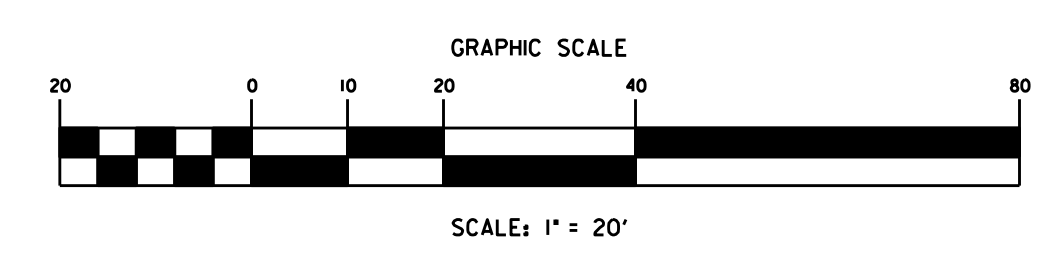

694-19-079

CITY OF BALTIMORE
DEPARTMENT OF TRANSPORTATION
TRANSPORTATION ENGINEERING AND CONSTRUCTION DIVISION

PRELIMINARY PLAT FOR THE CONDEMNATION AND CLOSING

OF (1) A 10 FOOT ALLEY EXTENDING FROM THE WEST SIDE OF DELAWARE AVENUE SOUTHWESTERLY 128.5 FEET, MORE OR LESS, (2) A 10 FOOT ALLEY EXTENDING FROM THE NORTHWEST SIDE OF VIRGINIA AVENUE NORTHWESTERLY 395.0 FEET, MORE OR LESS, TO THE SOUTHEAST SIDE OF WOODLAND AVENUE AND (3) A 10 FOOT ALLEY EXTENDING FROM THE WEST SIDE OF DELAWARE AVENUE SOUTHWESTERLY 198.5 FEET, MORE OR LESS.

CHIEF, SURVEY SECTION

CHIEF, TRANSPORTATION ENGINEERING AND CONSTRUCTION DIVISION

DIRECTOR, DEPARTMENT OF TRANSPORTATION

COMPUTED BY: W. PATTERSON
DRAWN BY: W. PATTERSON
CHECKED BY: P. MACKAY & J. STALEY

SCALE: 1" = 20'
DATE: MARCH 26, 2019
WARD 27, SECTION 18, BLOCK 4622
SURVEY SECTION
SHEET 1 OF 1

