

**SHEET NO. 25 OF THE ZONING MAP OF  
THE ZONING CODE OF BALTIMORE CITY**

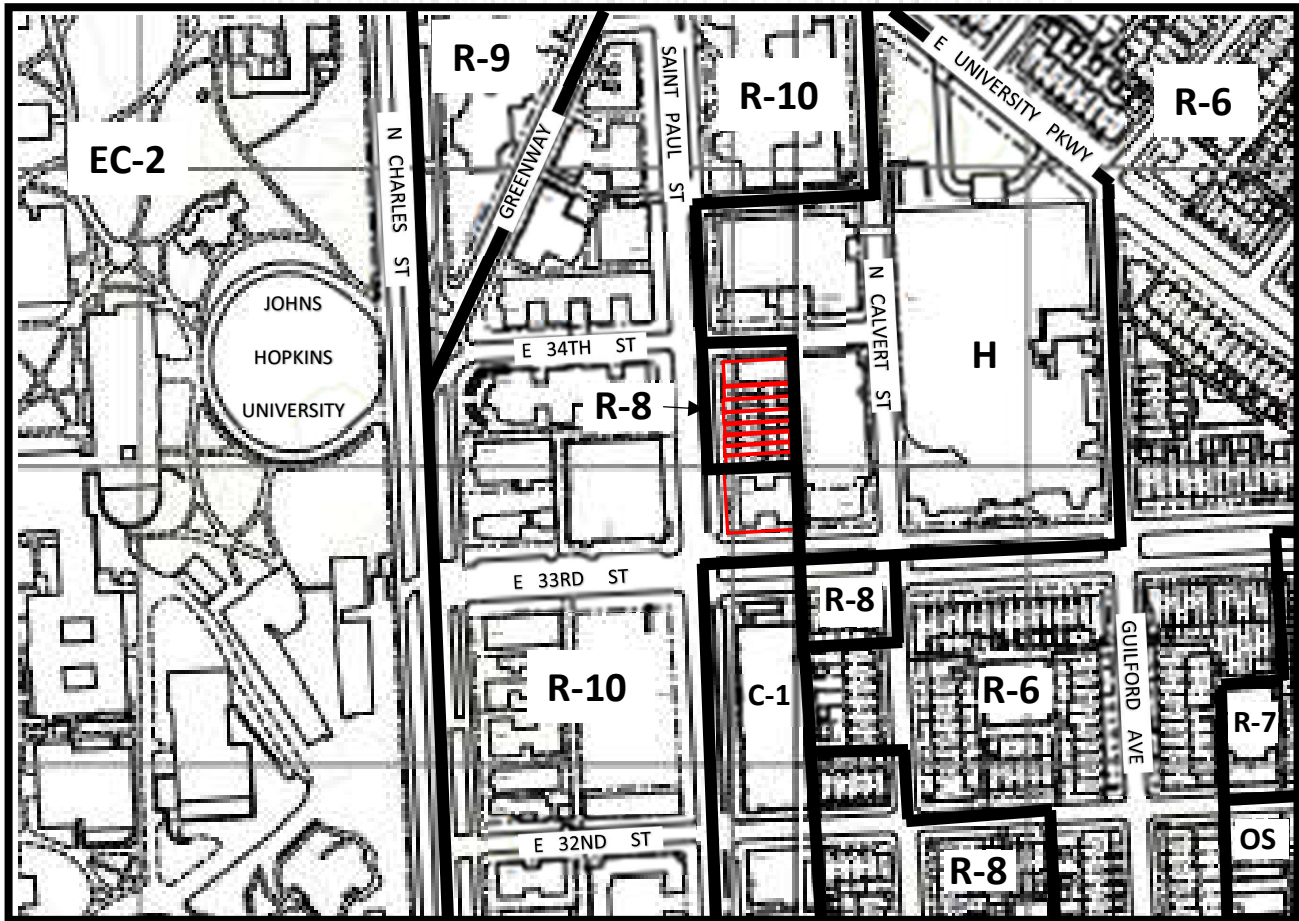

Scale: 1" = 300'

In Connection With The Property Known As No. 3301 SAINT PAUL STREET. The Applicant Wishes To Request The Rezoning Of The Aforementioned Property From R-10 Zoning District to C-1 Zoning District, As Outlined In Red Above.

In Connection With The Properties Known As Nos. 3311, 3313, 3315, 3317, 3319, 3321, 3323 AND 3327 SAINT PAUL STREET. The Applicant Wishes To Request The Rezoning Of The Aforementioned Properties From R-8 Zoning District to C-1 Zoning District, As Outlined In Red Above.

WARD 12      SECTION 19  
BLOCK 3871    LOT 10

WARD 12      SECTION 19  
BLOCK 3871    LOTS 1,3,4,5,6,7,8 & 9

\_\_\_\_\_

MAYOR

\_\_\_\_\_

PRESIDENT CITY COUNCIL

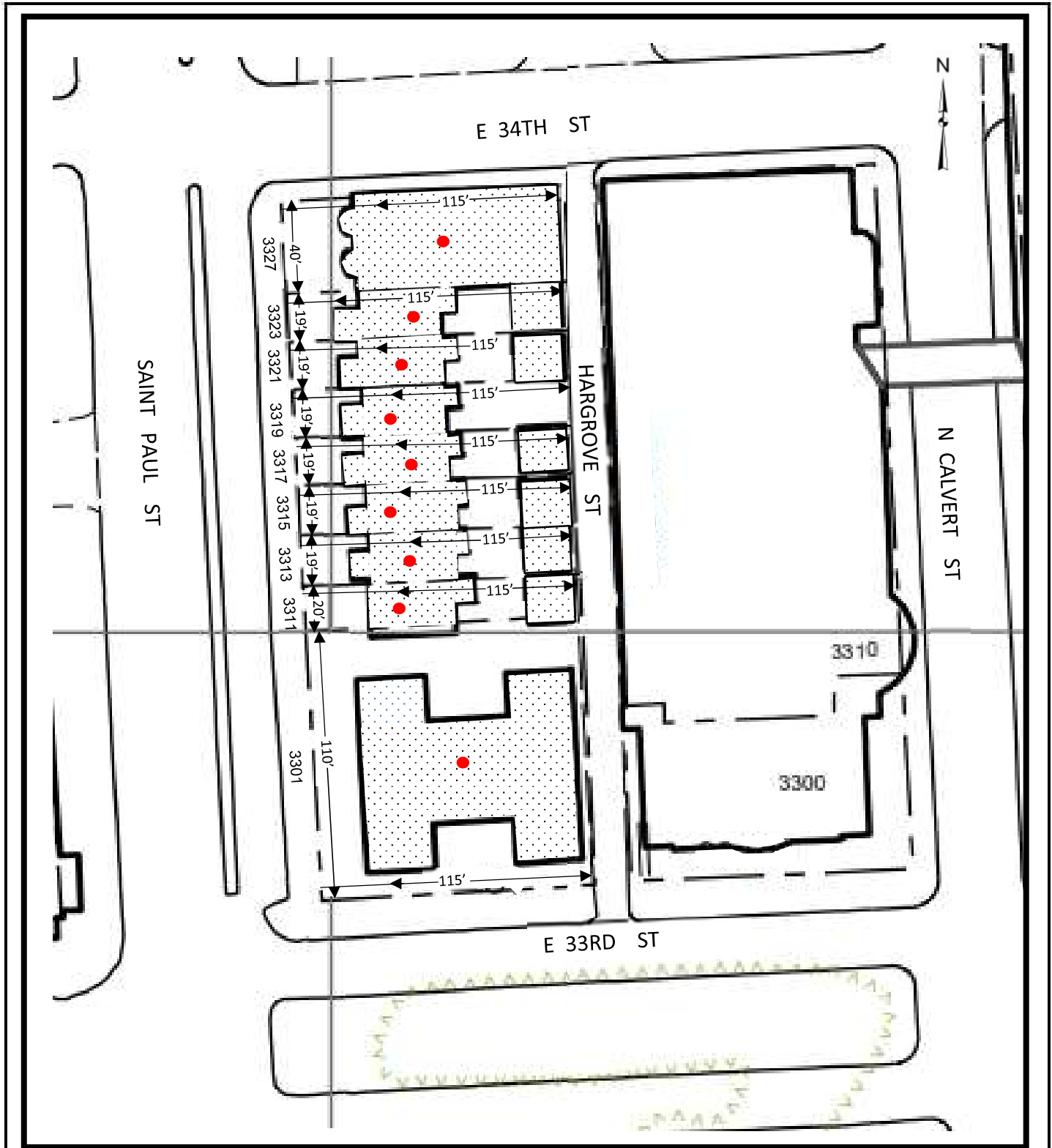

Scale: 1" = 60'

3301, 3311, 3313, 3315, 3317, 3319, 3321, 3323 and 3327 SAINT PAUL STREET

Sheet #2