

SHEET NO. 64 OF THE ZONING DISTRICT MAP OF BALTIMORE CITY ZONING CODE

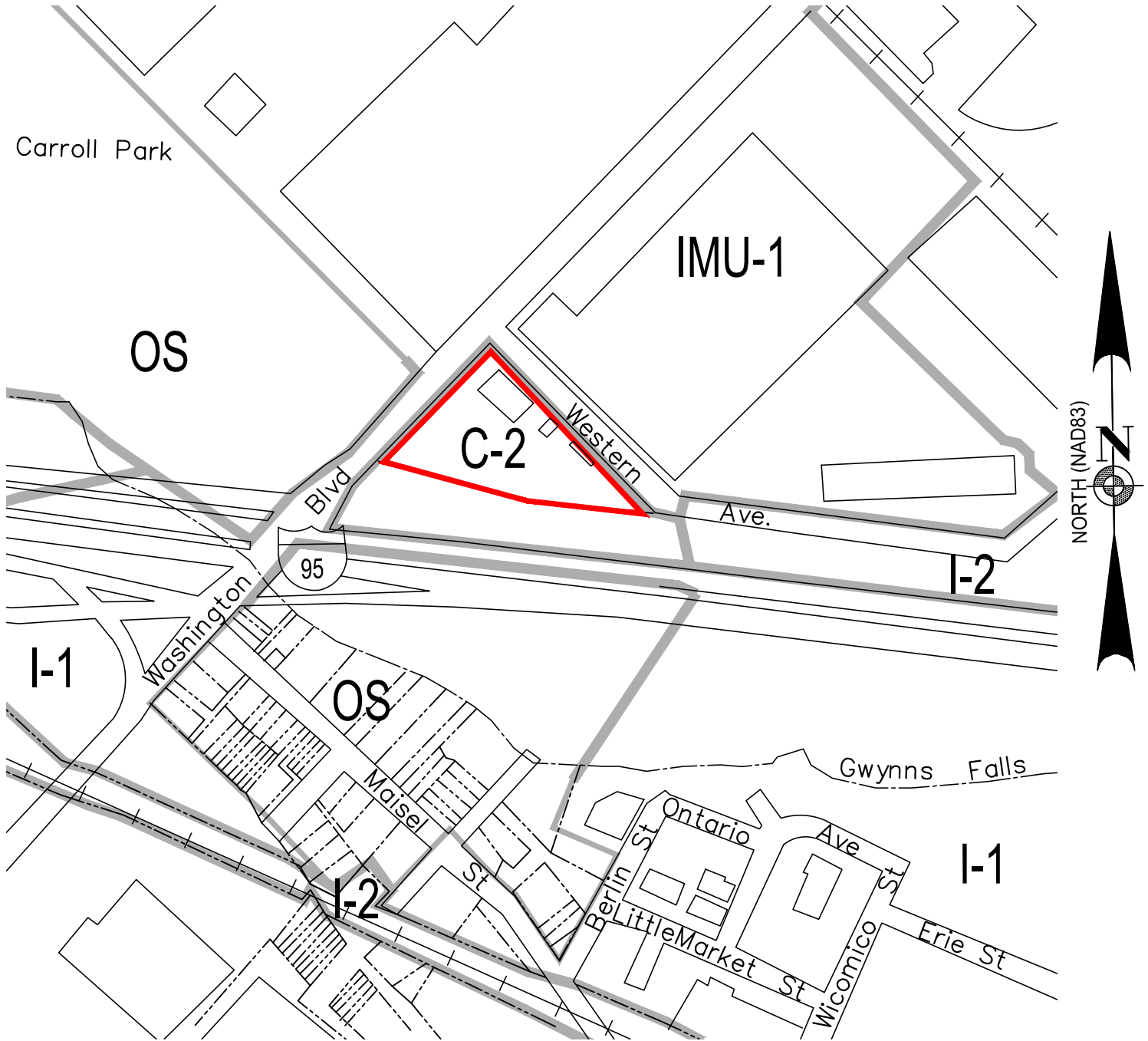

MAYOR

[Signature]
 PRESIDENT CITY COUNCIL

3-4-24

NOTE:

IN CONNECTION WITH THE PROPERTY KNOWN AS 2101 WASHINGTON BLVD. THIS APPLICANT WISHES TO REQUEST THE REZONING OF THE AFOREMENTIONED PROPERTY FROM C-2 ZONING TO I-1 AS OUTLINED IN RED ABOVE.

CMS Associates LLC

4925 Ellis Lane
 Ellicott City, Maryland 21043
 Tel. (410) 988-2436
 Contact: Geoffrey L. Ciniero, PE
 www.cms-engineering.net

2101 WASHINGTON BLVD.
 LOT 6

WARD 21 SECTION 05 BLOCK 770
 BALTIMORE CITY, MARYLAND

SCALE: 1"=300'

DATE: 10/07/2022

DRAWN BY: GLC

DESIGN BY: GLC

REVIEW BY: MAC

JOB NO: 22-058