

SHEET NO. 19 OF THE ZONING DISTRICT MAP OF THE BALTIMORE CITY ZONING CODE.

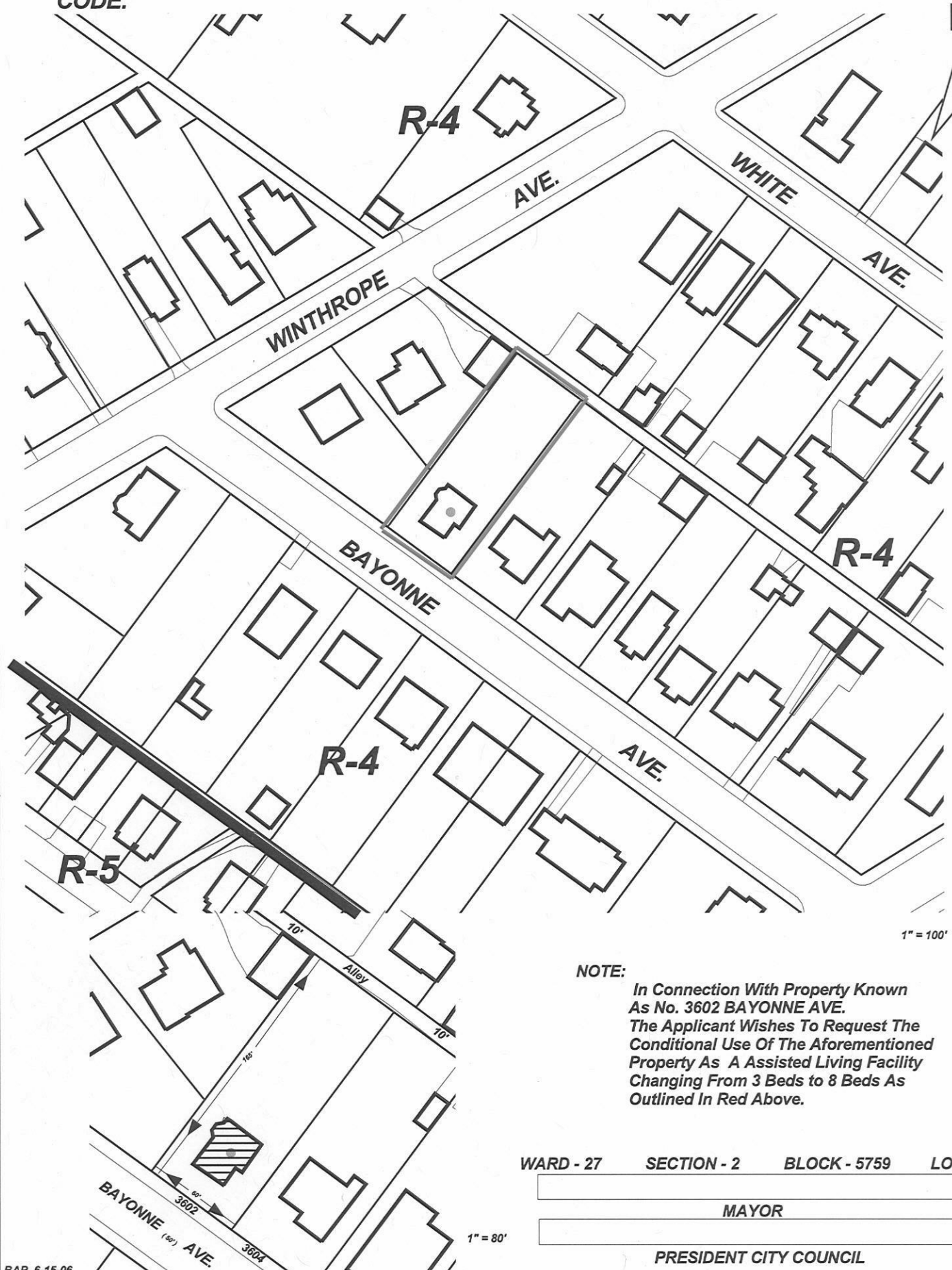

1" = 100'

NOTE:

In Connection With Property Known As No. 3602 BAYONNE AVE. The Applicant Wishes To Request The Conditional Use Of The Aforementioned Property As A Assisted Living Facility Changing From 3 Beds to 8 Beds As Outlined In Red Above.

WARD - 27 SECTION - 2 BLOCK - 5759 LOT - 13

MAYOR

PRESIDENT CITY COUNCIL