

**SHEET NO. 36 OF THE ZONING MAP OF
THE ZONING CODE OF BALTIMORE CITY**

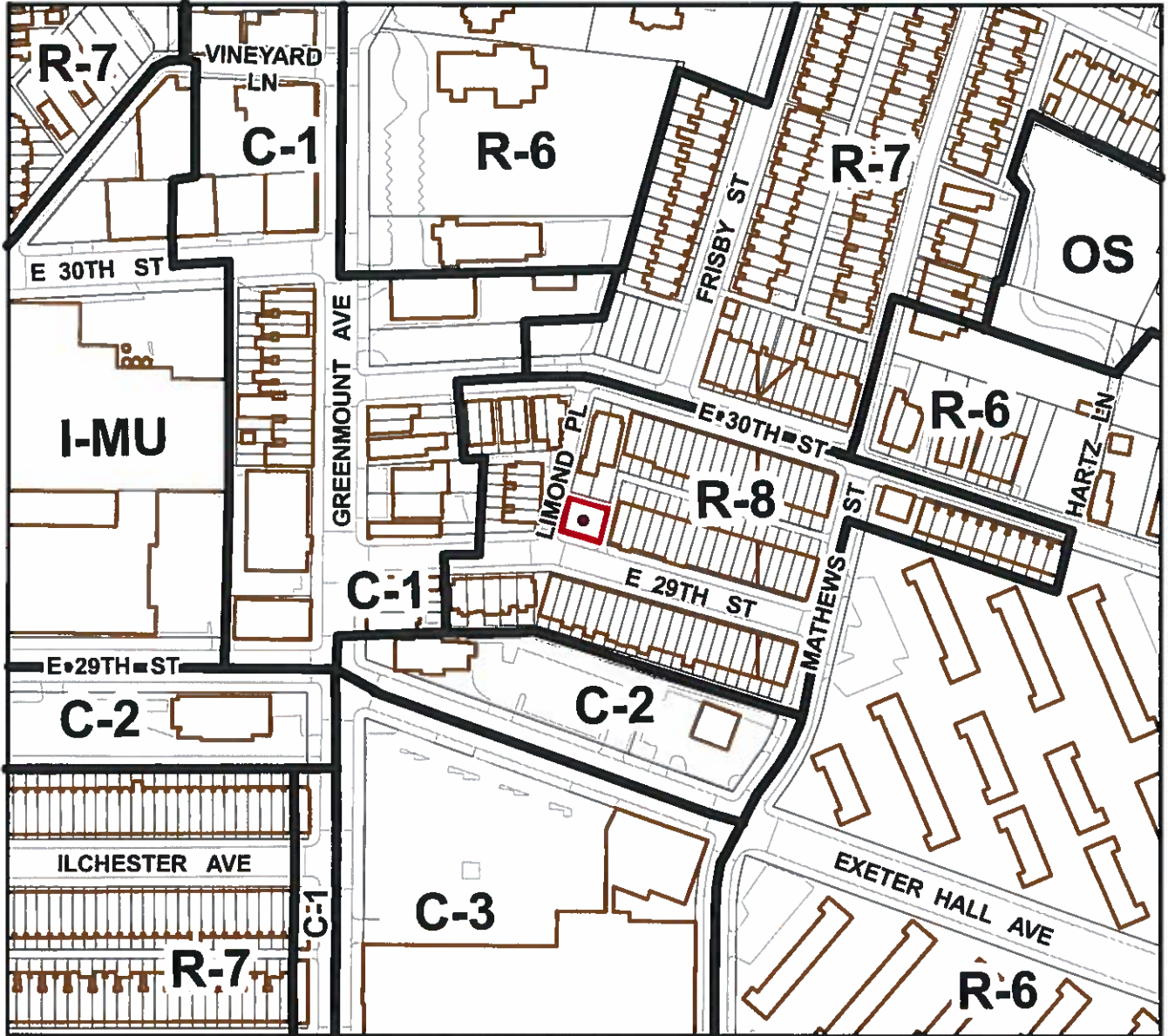

Scale: 1" = 200'

Note:

In Connection With The Property Known As
No. 600 EAST 29TH STREET. The
Applicant Wishes To Request The Conditional Use
Conversion Of The Aforementioned Property
From A Single Family Dwelling Unit To Two
Dwelling Units In The R-8 Zoning District,
As Outlined In Red Above.

WARD 9 SECTION 4
BLOCK 4072A LOT 33

MAYOR

PRESIDENT CITY COUNCIL

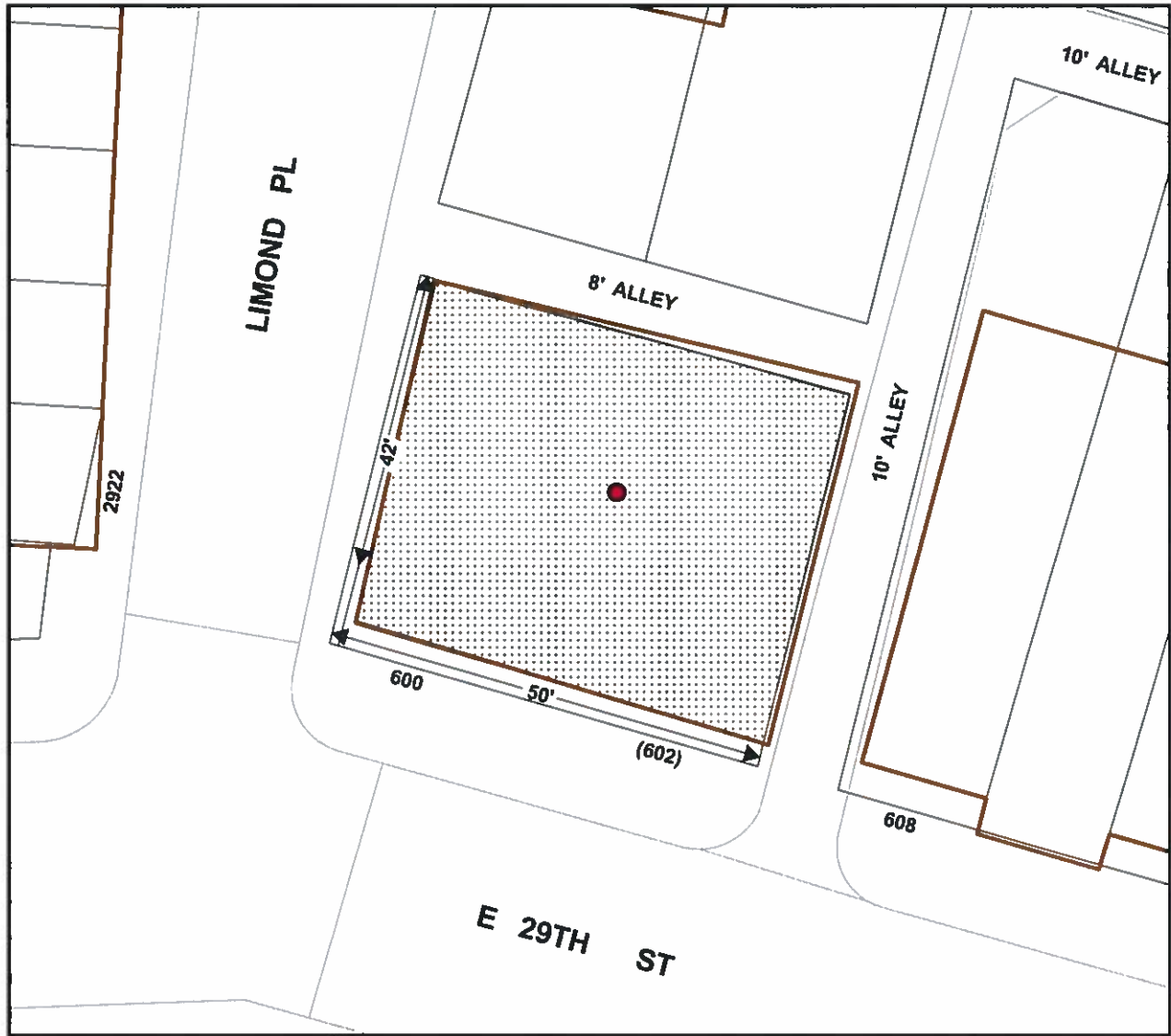

Scale: 1" = 20'

600 EAST 29TH STREET

Sheet #2