

REVISIONS

LOT 23A PER APP. 2062 C. Sh. 1412 7/23/31
 Lot 10 Dim Con Per P.S. C. Sh. 2014A
 House N.Y. Lays 1 & 65 Per P.S. C. Sh. 3249A.
 Lot 20 Divided Per Deed C. Sh. 5201
 Lot 20 New No. N. Ass'd Pl'd C. Sh. 5626A
 Lot 67 Per Deed C. Sh. 7681
 Lot 29 Div Con Per O.O. 8408A
 LOT 23 HO. NO. PER. C. Sh. 904A
 LOT 23 LOT NO. CHANGED PER C. Sh. 1010A
 Lot 33 Disc. Change Per App C. Sh. 9406B
 LOT 19/20 PER O.O. C. Sh. 1100
 LOT 21/31 PER APP. C. Sh. 1167

SHEET NOS. 12 AND 13 OF THE ZONING MAP OF THE ZONING CODE OF BALTIMORE CITY

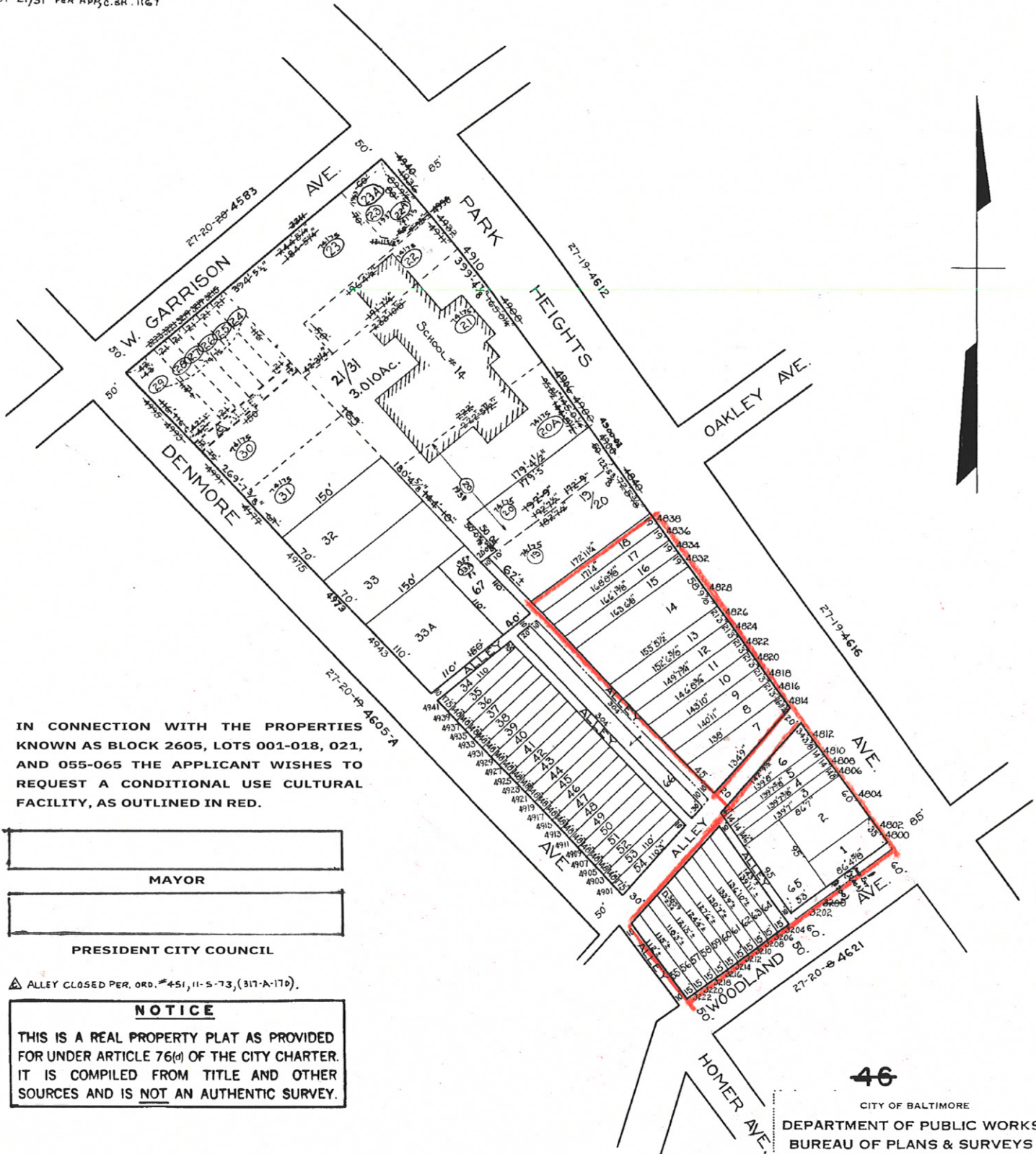

IN CONNECTION WITH THE PROPERTIES
 KNOWN AS BLOCK 2605, LOTS 001-018, 021,
 AND 055-065 THE APPLICANT WISHES TO
 REQUEST A CONDITIONAL USE CULTURAL
 FACILITY, AS OUTLINED IN RED.

MAYOR

PRESIDENT CITY COUNCIL

▲ ALLEY CLOSED PER. ORD. #451, 11-5-73, (317-A-170).

NOTICE

THIS IS A REAL PROPERTY PLAT AS PROVIDED
 FOR UNDER ARTICLE 76(1) OF THE CITY CHARTER.
 IT IS COMPILED FROM TITLE AND OTHER
 SOURCES AND IS NOT AN AUTHENTIC SURVEY.

NOTE ÷ BLOCK 27-20-10 FOR 1941.

TRACED BY: *G. Bauserfull*
 LETTERED BY: *G. Bauserfull*

CHECKED BY

46

CITY OF BALTIMORE
 DEPARTMENT OF PUBLIC WORKS
 BUREAU OF PLANS & SURVEYS
 PROPERTY LOCATION DIVISION

WARD 27 SECTION 20
 BLOCK 4605

SCALE 1" = 100 FT. DATE SEPT. 1931