

SHEET NO. 66 OF THE ZONING DISTRICT MAP OF BALTIMORE CITY ZONING CODE

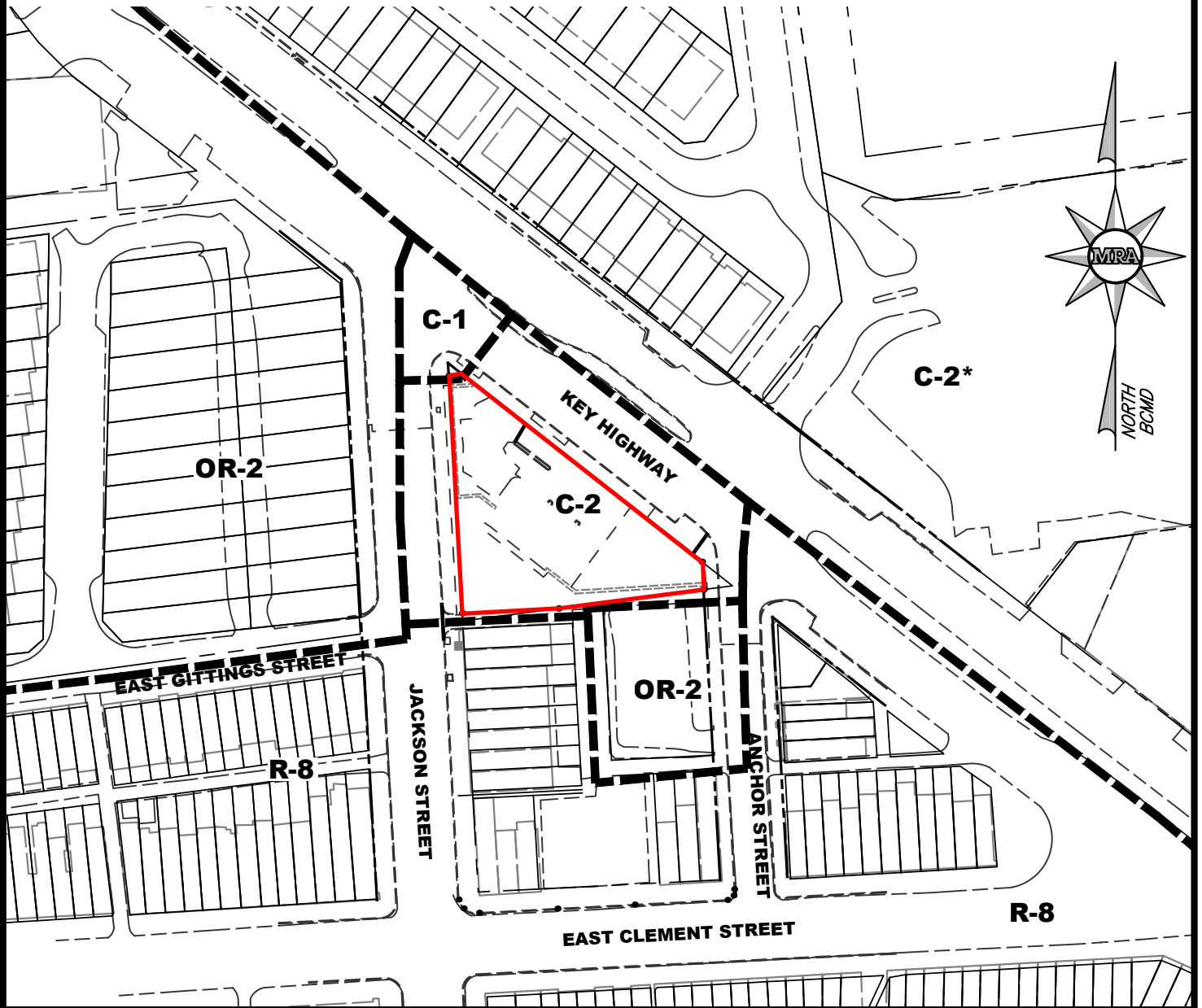

MAYOR

PRESIDENT CITY COUNCIL

NOTE:
 IN CONNECTION WITH THE PROPERTY
 KNOWN AS 1302 KEY HIGHWAY, THIS
 APPLICANT WISHES TO REQUEST THE
 REZONING OF THE AFOREMENTIONED
 PROPERTY FROM C-2 ZONING TO OR-2
 ZONING AS OUTLINED IN RED ABOVE.



MORRIS & RITCHIE ASSOCIATES, INC.
 ENGINEERS, ARCHITECTS, PLANNERS, SURVEYORS AND LANDSCAPE ARCHITECTS
 1220-B E. JOPPA RD., SUITE 400K
 TOWSON, MD 21286
 (410) 821-1690
 DKESSLER@MRAGTA.COM
 MRAGTA.COM
 Copyright 2023 Morris & Ritchie Associates, Inc.

1302 KEY HIGHWAY

LOT 34A

WARD 24, SECTION 13, BLOCK 1927A
 BALTIMORE CITY, MARYLAND

SCALE: 1" = 100'	DATE: 01/16/2023	DRAWN BY: DJK	DESIGN BY: DJK	REVIEW BY: JLB	JOB NO. : 21619
------------------	------------------	---------------	----------------	----------------	-----------------