

SHEET NO. 47 OF THE ZONING DISTRICT MAP OF THE BALTIMORE CITY ZONING CODE.

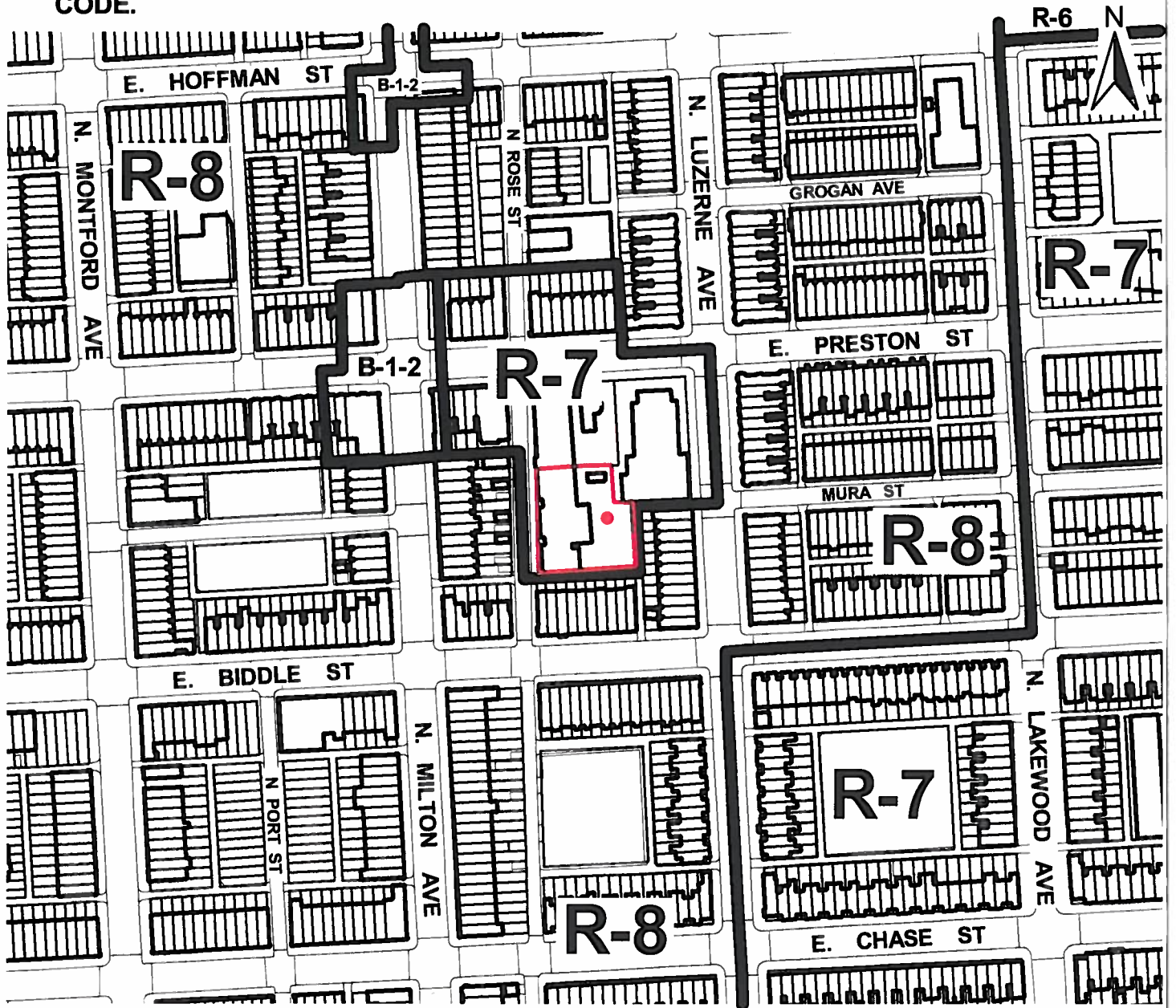

1" = 200'

Note:

In Connection With Property Known As
No. 1209 NORTH ROSE STREET.
The Applicant Wishes To Request The
Conditional Rezoning Of The Aforementioned
Property From R-7 Zoning to R-8 Zoning,
As Outlined In Red Above.

WARD - 8 SECTION - 15 BLOCK - 1538 LOT - 37

MAYOR

PRESIDENT CITY COUNCIL

466



E. PRESTON ST (66')

2515 - 2521

N. LUZERNE AVE (70')

N ROSE ST

10' ALLEY

10' ALLEY

N. MILTON AVE (70')

10' ALLEY

10' ALLEY

0.360 AC.

10' ALLEY

E. BIDDLE ST (66')

1209

2514

1" = 60'

1209 NORTH ROSE STREET

Sheet #2