

**SHEET NO. 59 OF THE ZONING DISTRICT MAP OF BALTIMORE CITY ZONING CODE**

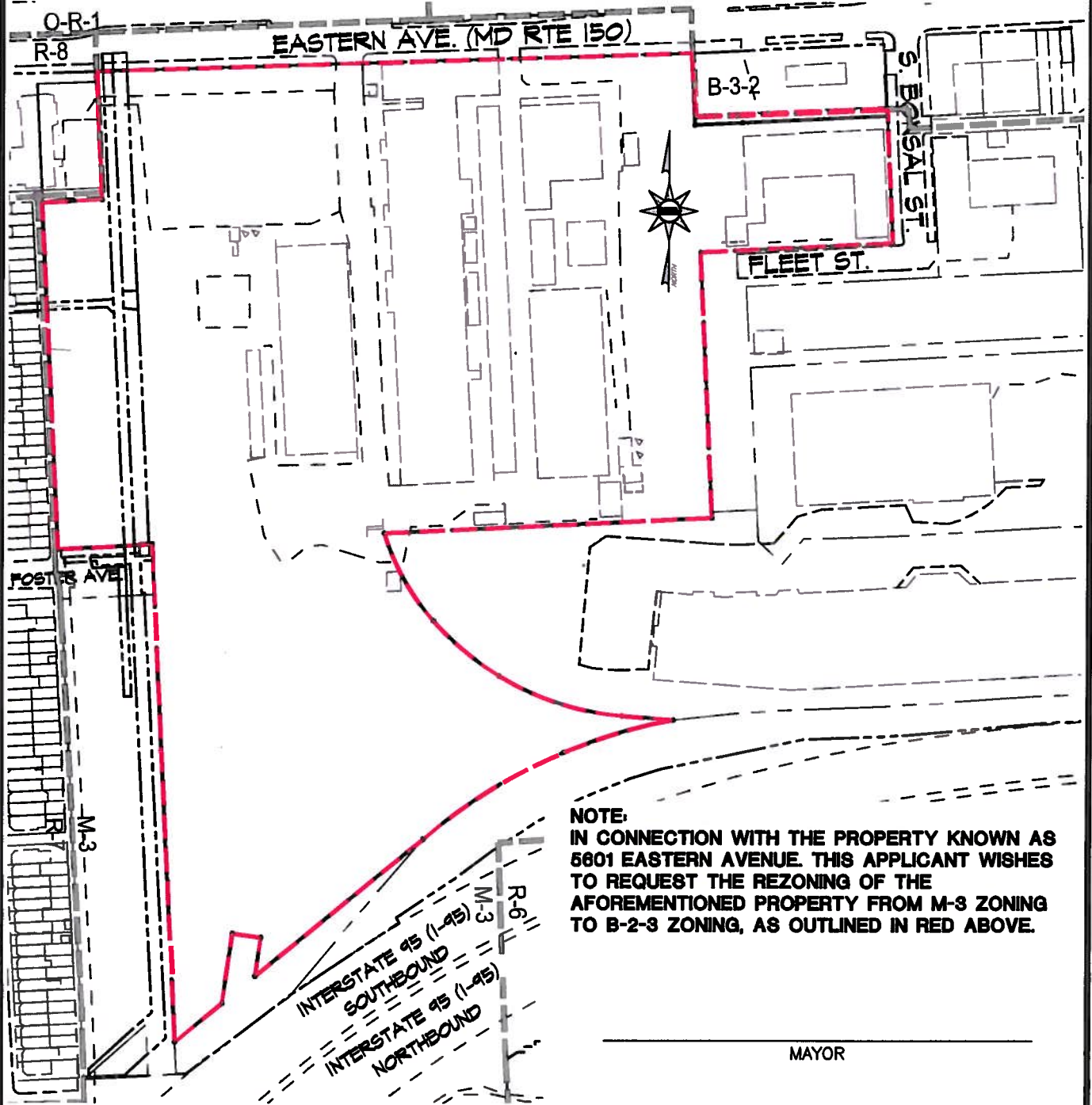

**NOTE:**  
 IN CONNECTION WITH THE PROPERTY KNOWN AS  
 5601 EASTERN AVENUE. THIS APPLICANT WISHES  
 TO REQUEST THE REZONING OF THE  
 AFOREMENTIONED PROPERTY FROM M-3 ZONING  
 TO B-2-3 ZONING, AS OUTLINED IN RED ABOVE.

\_\_\_\_\_  
 MAYOR

\_\_\_\_\_  
 PRESIDENT CITY COUNCIL



**MORRIS & RITCHIE ASSOCIATES, INC.**  
 ENGINEERS, ARCHITECTS, PLANNERS, SURVEYORS AND LANDSCAPE ARCHITECTS  
 14280 PARK CENTER DRIVE  
 LAUREL, MD 20707  
 (410) 792-9792 / (301) 776-1690  
 FAX: (410) 792-7395  
 MRAGTA.COM  
 Copyright 2015 Morris & Ritchie Associates, Inc.

**5601 EASTERN AVENUE**  
 LOT 28

WARD 26, SECTION 1, BLOCK 6994  
 BALTIMORE CITY, MARYLAND

SCALE: 1" = 200'	DATE: 2/12/2015	DRAWN BY: JTS	DESIGN BY: JTS	REVIEW BY: JTS	JOB NO. : 18297
------------------	-----------------	---------------	----------------	----------------	-----------------

505