

**SHEET NO. 22/23 OF THE ZONING DISTRICT MAP
OF THE BALTIMORE CITY ZONING CODE**

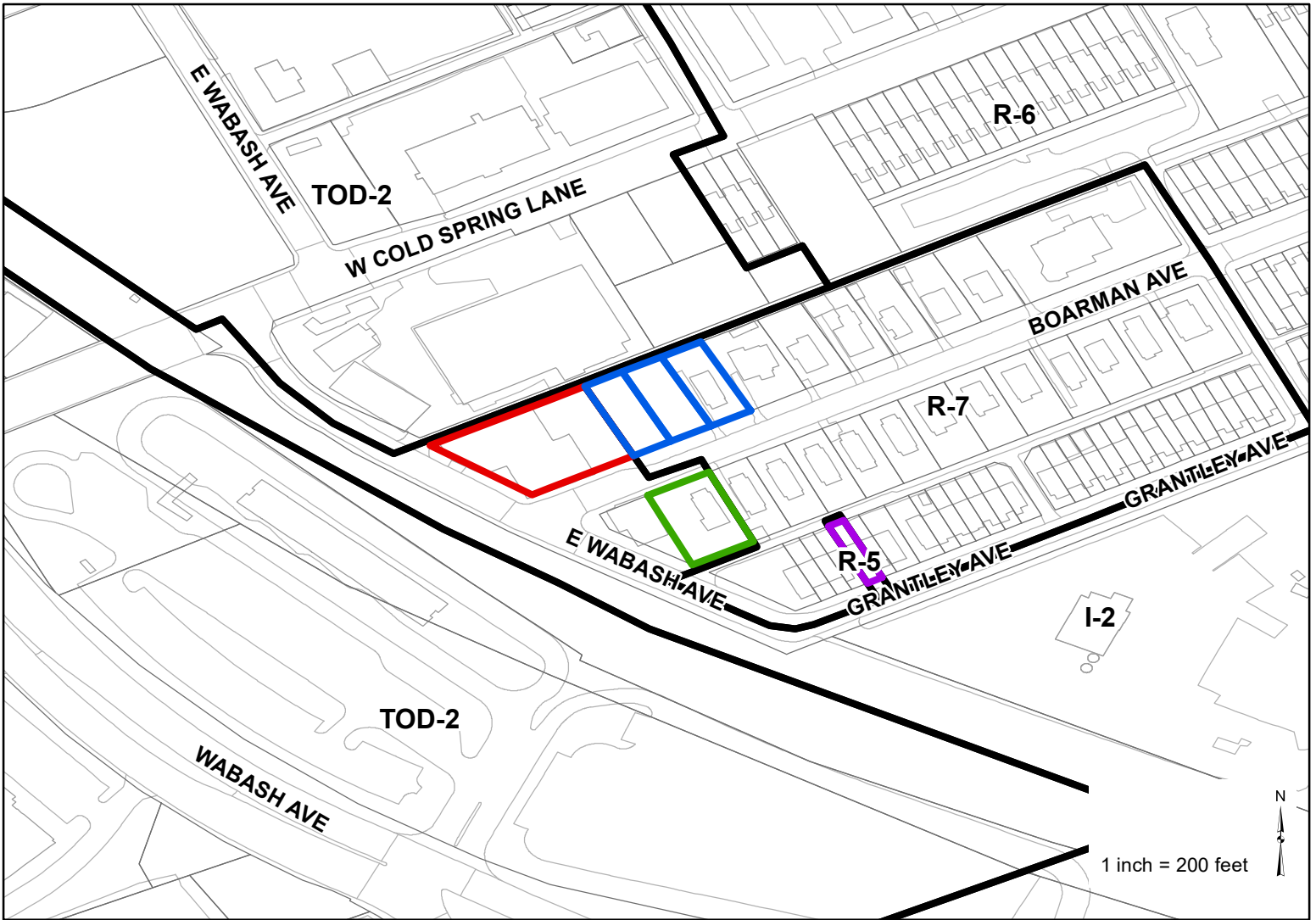

In Connection With The Property
Known As No. 3006 BOARMAN AVENUE.
The Applicant Wishes To Request The
Rezoning Of The Aforementioned Property
From I-2 Zoning To TOD-2 Zoning, As
Outlined In Red Above.

Ward 15 Section 35 Block 3185 Lot 048

In Connection With The Property
Known As No. 2925 BOARMAN AVE.
The Department Of Planning Wishes To
Request The Rezoning Of The Aforementioned
Property From I-2 Zoning To R-7 Zoning, As
Outlined In Green Above.

Ward 15 Section 35 Block 3187 Lot 013

In Connection With The Properties
Known As No. 2926, 2928 BOARMAN AVENUE
And NWS BOARMAN AVENUE 125 FT, NE OF
WMRR RW. The Applicant Wishes To Request
The Rezoning Of The Aforementioned Properties
From R-7 Zoning To TOD-2 Zoning, As Outlined
In Blue Above.

Ward 15 Section 35 Block 3185 Lots 049, 050, 051

In Connection With The Property
Known As No. 3048 GRANTLEY AVE.
The Department Of Planning Wishes To
Request The Rezoning Of The Aforementioned
Property From R-5 Zoning To R-7 Zoning, As
Outlined In Purple Above.

Ward 15 Section 35 Block 3187 Lot 041

Mayor

President, City Council